

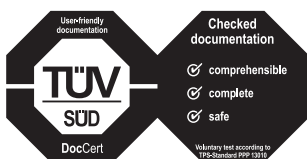

IMPRESSA Xs95/Xs90 One Touch– Quick Reference Guide



The 'IMPRESSA Manual' together with these short instructions 'IMPRESSA Xs95/Xs90 One Touch – Quick Reference Guide' has been awarded the seal of approval by the independent German Technical Inspection Agency, TÜV SÜD, due to its easy-to-understand style, its thoroughness and coverage of safety aspects.



These short instructions do not replace the 'IMPRESSA Xs95/Xs90 One Touch Manual'. Make sure you read and observe the safety information and warnings first in order to avoid hazards.

Switching on

When the IMPRESSA is switched on, a prompt for the rinse operation automatically appears which is initiated by pressing the maintenance button.

Precondition: Your IMPRESSA is switched on at the power switch and the on/off button  is illuminated (standby).

- ▶ Press the on/off button to switch the IMPRESSA on.

WELCOME TO JURA appears briefly on the display.

HEATING UP

PRESS RINSE, the maintenance button  lights up.

- ▶ Place a receptacle under the coffee spout.

-  ▶ Press the maintenance button.

The machine rinses itself, stopping automatically.

COFFEE READY appears on the display. Your IMPRESSA is ready to use.



Using and activating filter

Your IMPRESSA no longer has to be descaled if you are using CLARIS filter cartridges.

- i** Perform the 'Insert filter' operation without interruptions. This will ensure that your IMPRESSA always produces its best.

Precondition: **COFFEE READY** is displayed.

- ▶ Open the cover of the Rotary Switch.

-  ▶ Keep the Rotary Switch pressed **until** **MAINTENANCE** appears on the display.

-  ▶ Turn the Rotary Switch until **FILTER NO** is displayed.

-  ▶ Press the Rotary Switch to enter the programme item.

FILTER NO

-  ▶ Turn the Rotary Switch until **FILTER YES** is displayed.

- ▶ Press the Rotary Switch to confirm the setting.
CONFIRMED ✓ appears briefly on the display to confirm the setting.

INSERT FILTER / PRESS RINSE, the maintenance button  lights up.

- ▶ Remove a CLARIS filter cartridge and the filter cartridge extension from the Welcome Pack.
- ▶ Fit the extension on top of the filter cartridge.
- ▶ Remove the water tank and empty it.
- ▶ Lift the cartridge holder and insert the filter cartridge into the water tank, applying slight pressure.
- ▶ Close the cartridge holder. It will click into place audibly.
- ▶ Fill the water tank with fresh, cold water and reinsert.

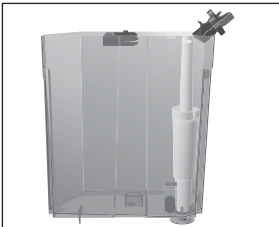

- ▶ Place a receptacle (at least 500 ml) under the frother.

- i** If you are using the **Professional Cappuccino Frother**, set the selection lever of the frother to the steam position .

-  ▶ Press the maintenance button.

FILTER RINSING, water flows out of the frother.

- i** You can interrupt rinsing of the filter at any time by pressing any button.

- i** The water may be slightly discoloured. This is not harmful to health and does not affect the taste.

Filter rinsing stops automatically after approx. 500 ml.
COFFEE READY appears on the display. The filter is now activated.



Changing the filter

- i** After 50 litres of water have flowed through, the filter will cease to work. Your IMPRESSA will automatically prompt you to replace the filter.
- i** After two months, the filter will cease to work. Monitor the elapsed time by adjusting the date plate on the cartridge holder.
- i** If the CLARIS filter cartridge is not activated, you will not be prompted to change the filter.

To change the CLARIS filter cartridge when prompted to do so by your IMPRESSA, proceed as follows:

Precondition: COFFEE READY / CHANGE FILTER is displayed, and the maintenance button ☼ lights up.

- ☼ ▶ Press the maintenance button.

DURATION 2 MIN. / START YES

- i** If you want to change the filter at a later point in time, turn the Rotary Switch until START NO is displayed. Exit the maintenance programme by pressing the Rotary Switch. The prompt 'Change filter' remains on the display.

- ☼ ▶ Press the maintenance button.

CHANGE FILTER / PRESS RINSE

- ▶ Remove the water tank and empty it.
- ▶ Lift the cartridge holder.
- ▶ Take out the old CLARIS filter cartridge and the extension.
- ▶ Fit the extension on top of a new filter cartridge.
- ▶ Insert the filter cartridge into the water tank, exerting slight pressure.
- ▶ Close the cartridge holder. It will click into place audibly.
- ▶ Fill the water tank with fresh, cold water and reinsert.





- ▶ Place a receptacle (at least 500 ml) under the frother.

i If you are using the **Professional Cappuccino Frother**, set the selection lever of the frother to the steam position ↓.

- ⚡ ▶ Press the maintenance button.

FILTER RINSING, water flows out of the frother.

i You can interrupt filter rinsing at any time. To do this, press any button.

i The water may be slightly discoloured. This is not harmful to health and does not affect the taste.

Filter rinsing stops automatically after approx. 500 ml. The IMPRESSA heats up and is once again ready to use.

Cleaning the machine

After 220 coffee preparations or 80 switch-on rinses, the IMPRESSA will prompt you to clean it.

CAUTION

If the wrong cleaning agent is used, the machine could be damaged and/or traces of detergent could be left behind in the water.

- ▶ Use only original JURA care products.

i The cleaning programme only lasts about 20 minutes.

i Do not interrupt the cleaning programme. The quality of cleaning will be impaired if you do so.

i JURA cleaning tablets are available from stockists.

Precondition: **COFFEE READY / CLEAN MACHINE** is displayed, and the maintenance button ⚡ lights up.

- ⚡ ▶ Press the maintenance button.

DURATION 20 MIN. / START YES

i If you want clean the machine at a later point in time, turn the Rotary Switch until **START NO** is displayed. Exit the maintenance programme by pressing the Rotary Switch. The prompt 'Clean machine' remains on the display.

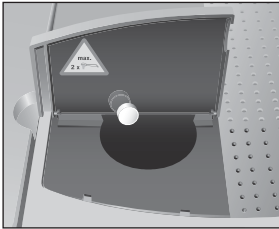

- ❖ ▶ Press the maintenance button.
EMPTY TRAY
- ▶ Empty the drip tray and coffee grounds container and put them back into the machine.
PRESS RINSE, the maintenance button ❖ lights up.
- ▶ Place a receptacle under the coffee spout and the frother.
- ❖ ▶ Press the maintenance button.
CLEANS, the cleaning operation starts.
The process is interrupted. **ADD TABLET / PRESS RINSE**, the maintenance button ❖ lights up.
- ▶ Open the cover of the filler funnel for pre-ground coffee.
- ▶ Insert a JURA cleaning tablet into the filler funnel.
- ▶ Close the cover of the filler funnel.
- ❖ ▶ Press the maintenance button.
CLEANS, water flows out of the coffee spout and the frother several times.
- i** You can follow the current status of cleaning on the progress bar.
- The process is interrupted, **EMPTY TRAY**.
- ▶ Empty the drip tray and coffee grounds container and put them back into the machine.
The cleaning operation is now complete. The IMPRESSA is ready for use again.

Descaling the machine

The IMPRESSA builds up deposits of limescale over time and automatically prompts you to descale it when necessary. The degree of calcification depends on the degree of hardness of your water.



If the descaling agent comes into contact with the skin or eyes, this can cause irritation.

- ▶ Avoid contact with the skin or eyes.
- ▶ Rinse the descaling agent off with clean water. Should you get any descaling agent in your eye, see a doctor.



If the wrong descaling agent is used, the machine could be damaged and/or traces of detergent could be left behind in the water.

- ▶ Use only original JURA care products.



If the descaling operation is interrupted, there may be damage to the machine.

- ▶ Allow the descaling program to run to the end.



If the descaling agent comes into contact with sensitive surfaces, damage cannot be ruled out.

- ▶ Clean up any splashes immediately.

- i** The descaling programme lasts approx. 45 minutes.
- i** JURA descaling tablets are available from stockists.
- i** If you use a CLARIS filter cartridge and this is activated, you will not be prompted to change the filter.
- i** Remove the CLARIS filter cartridge, if installed, before descaling the machine.

Precondition: COFFEE READY / DECALCIFY MACHINE is displayed and the maintenance button  lights up.

-  ▶ Press the maintenance button.

DURATION 45 MIN. / START YES

- i** If you want to descale the machine at a later point in time, turn the Rotary Switch until START NO is displayed. Exit the maintenance programme by pressing the Rotary Switch. The prompt 'Decalcify machine' remains on the display.

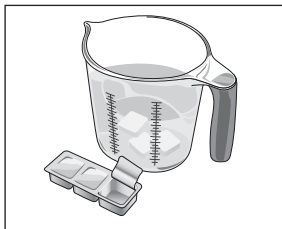

- ⚡ ▶ Press the maintenance button.
EMPTY TRAY
- ▶ Empty the drip tray and coffee grounds container and put them back into the machine.
SOLVENT IN TANK
- ▶ Remove the water tank and empty it.
- ▶ Completely dissolve the contents of one blister (3 JURA descaling tablets) in a container that holds 600 ml of water. This may take several minutes.
- ▶ Pour the solution into the empty water tank and insert it in the machine.
SOLVENT IN TANK / PRESS RINSE, the maintenance button ⚡ lights up.
- ▶ Remove the frother from the Connector System®.
- ▶ Place a receptacle under the hot water spout and another under the Connector System®.
- ⚡ ▶ Press the maintenance button.
DECALCS, water flows out of the Connector System® and the hot water spout. The maintenance button ⚡ flashes during the descaling operation.

i You can follow the current status of descaling on the progress bar.

- The process is interrupted, **EMPTY TRAY**.
- ▶ Empty the receptacles below the hot water spout and the Connector System®.
- ▶ Empty the drip tray and coffee grounds container and put them back into the machine.
RINSE WATER TANK / FILL WATER TANK
- ▶ Remove the water tank and rinse it thoroughly.
- ▶ Fill the water tank with fresh, cold water and reinsert.
PRESS RINSE, the maintenance button ⚡ lights up.
- ▶ Refit the frother.



- ▶ Place a receptacle under the coffee and hot water spout and another under the frother.
- ⚡ ▶ Press the maintenance button.
DECALCS, water flows out of the frother and the hot water spout.
 The process is interrupted, **HEATING UP**.
MACHINE RINSING, water flows out of the coffee spout. The operation stops automatically, **EMPTY TRAY**.
- ▶ Empty the drip tray and coffee grounds container and put them back into the machine.
 The descaling operation is now complete. Your IMPRESSA heats up and is once again ready to use.

i If the descaling operation stops unexpectedly, rinse the water tank thoroughly.

i This chapter applies to the **Professional** and **Easy Cappuccino Frothers**.

Rinsing the cappuccino frother

Each time milk has been prepared the IMPRESSA displays a prompt for Cappuccino rinsing.

Precondition: **COFFEE READY / RINSE CAPPUCCINO** is displayed and the maintenance button ⚡ lights up.

- ▶ Place a receptacle under the frother.

i If you are using the **Professional Cappuccino Frother**, turn the selection lever to the steam position ⚡.

- ⚡ ▶ Press the maintenance button.

CAPPU. RINSING, the frother is rinsed.

The procedure stops automatically. **COFFEE READY** appears on the display.



Cleaning the cappuccino frother

i This chapter applies to the **Professional** and **Easy Cappuccino Frothers**.

To ensure that the respective frother works perfectly, you should clean it **daily** when you have been preparing milk.





CAUTION

If the wrong cleaning agent is used, the machine could be damaged and/or traces of detergent could be left behind in the water.



- ▶ Use only original JURA care products.

i The JURA Cappuccino Cleaner is available from stockists.

Precondition: **COFFEE READY** is displayed.

- ▶ Open the cover of the Rotary Switch.
-  ▶ Keep the Rotary Switch pressed **until MAINTENANCE** appears.
-  ▶ Press the Rotary Switch to enter the programme item. **CLEAN CAPPUCCINO**
-  ▶ Press the Rotary Switch. **CLEANER FOR CAPPU.**, the maintenance button  lights up.
- ▶ Pour 250 ml of fresh water into a container and add one capful (max. 15 ml) of Cappuccino Cleaner.
- ▶ Immerse the milk pipe in the receptacle with the cleaning solution.

i If you are using the **Professional Cappuccino Frother**, turn the selection lever to the milk foam  or milk  position.

- ▶ Place another receptacle under the frother.
-  ▶ Press the maintenance button. **CAPPUCCINO CLEANING**, the frother and pipe are cleaned. **WATER FOR CAPPUCCINO**, the maintenance button  lights up.
- ▶ Rinse the receptacle thoroughly, fill it with approx. 250 ml of fresh water and immerse the milk pipe in the water.





- ▶ Empty the other receptacle and place it under the frother once more.
- ⚠ ▶ Press the maintenance button.
CAPPUCCINO CLEANING, the frother and pipe are rinsed with fresh water.
COFFEE READY appears on the display. Your IMPRESSA is once more ready to use.

Disassembling and rinsing the Professional Cappuccino Frother

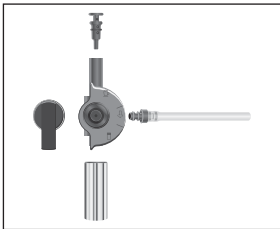

- ▶ Carefully remove the frother from the Connector System[®] by twisting slightly.
- ▶ Dismantle the frother completely.
- ▶ Rinse all the frother parts thoroughly under running water.
- ▶ Reassemble the frother.

i Ensure that the individual parts are correctly and firmly attached to one another to ensure optimum function of the frother.

- ▶ Firmly attach the frother to the Connector System[®].

Disassembling and rinsing the Easy Cappuccino Frother

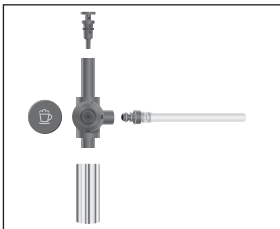

- ▶ Carefully remove the frother from the Connector System[®] by twisting slightly.
- ▶ Dismantle the frother completely.
- ▶ Rinse all the frother parts thoroughly under running water.
- ▶ Reassemble the frother.

i Ensure that the individual parts are correctly and firmly attached to one another to ensure optimum function of the frother.

- ▶ Firmly attach the frother to the Connector System[®].